

\$28 - 1305 Rocky Creek Rd Cru 1, Ladysmith

MLS® #1016100

\$28

Bedroom, Bathroom, 1,500 sqft
Commercial Lease

N/A, Ladysmith, BC

CRU1 â€“ Building A at Marina View Estates is a 1,500 SF office or retail unit located just 500 metres from the Ladysmith Harbour, and 3 minutes off of the highway and downtown Ladysmith.

With a completion date of Q2-Q3, 2026, this development offers ample parking, and customizable shell condition spaces for a wide range of businesses. Permitted uses include, but are not limited to: office, medical, veterinary, personal service, cafÃ©, bakery, community care, or retail.

CRU 1 can be combined with CRU 2, for total of 3,020 SF. Building B CRUs available for SF needs up to ~8,350 SF. Inducement packages are available, please contact listing agent for more information.

200A 3-Phase power, 3 ton HVAC systems per unit. Full shell condition details upon request.

Essential Information

MLS® #	1016100
Price	\$28
Square Footage	1,500
Type	Commercial Lease
Sub-Type	Office
Status	Active

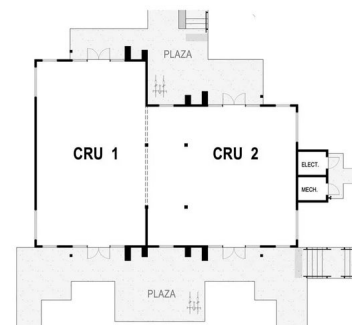

FLOOR PLAN - BUILDING A



Community Information

Address	1305 Rocky Creek Rd Cru 1
Area	Du Ladysmith
Subdivision	N/A
City	Ladysmith
County	Cowichan Valley Regional District
Province	BC
Postal Code	V9G 1K4

Interior

Heating	Heat Pump
Cooling	HVAC

Additional Information

Date Listed	October 8th, 2025
Days on Market	6
Office	RE/MAX Camosun

Listing Details

Listing Office	RE/MAX Camosun
----------------	----------------

MLS® property information is provided under copyright© by the Vancouver Island Real Estate Board and Victoria Real Estate Board. The information is from sources deemed reliable, but should not be relied upon without independent verification.